

Using the OPTIMA^{INT}



Attachment

Attachments are pre-programmed with the correct ratio, top speed, and recommended torque.

Click the and arrows to scroll through attachment presets.

Cursor

The cursor highlights what is or can be selected (speed, setting, etc.).

Touchpad Availability

The arrow icons identify which way you can go with the cursor.

In this example, you can move the cursor right or down.

REV = Reverse

Reverses the rotation of the bur or file.

ESC = Back

Escape will take you back to the previous screen.

SETUP = Settings

Change light intensity, sound, and other settings.

MAY NOT BE AVAILABLE FOR STUDENTS.

SAVE = Keep New Settings

Press save if/when you make an adjustment in the setup menu.

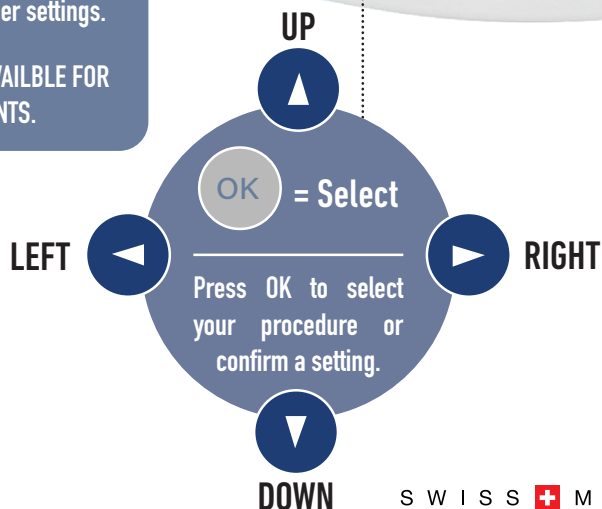

SWISS MADE

For videos and more:

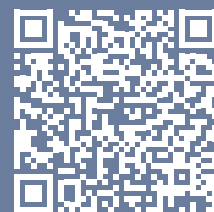

bienairacademy.com